

LOCATION DETAILS

SCALE:- 1:100

R.S. DAG NO.- 213, R.S. KHATIAN NO.- 107, L.R. DAG NO:- 984, L.R. KHATIAN NO:- 2489, 2490, SHEET NO:- 23, MOUZA & P.S.:- CHANDERNAGORE, J.L NO:- 1, BOROUGH NO:- III, HOLDING NO:- 1195, WARD NO:- 18, AT MONDAL BAGAN, UNDER CHANDERNAGORE MUNICIPAL CORPORATION, DIST:-HOOGHLY.

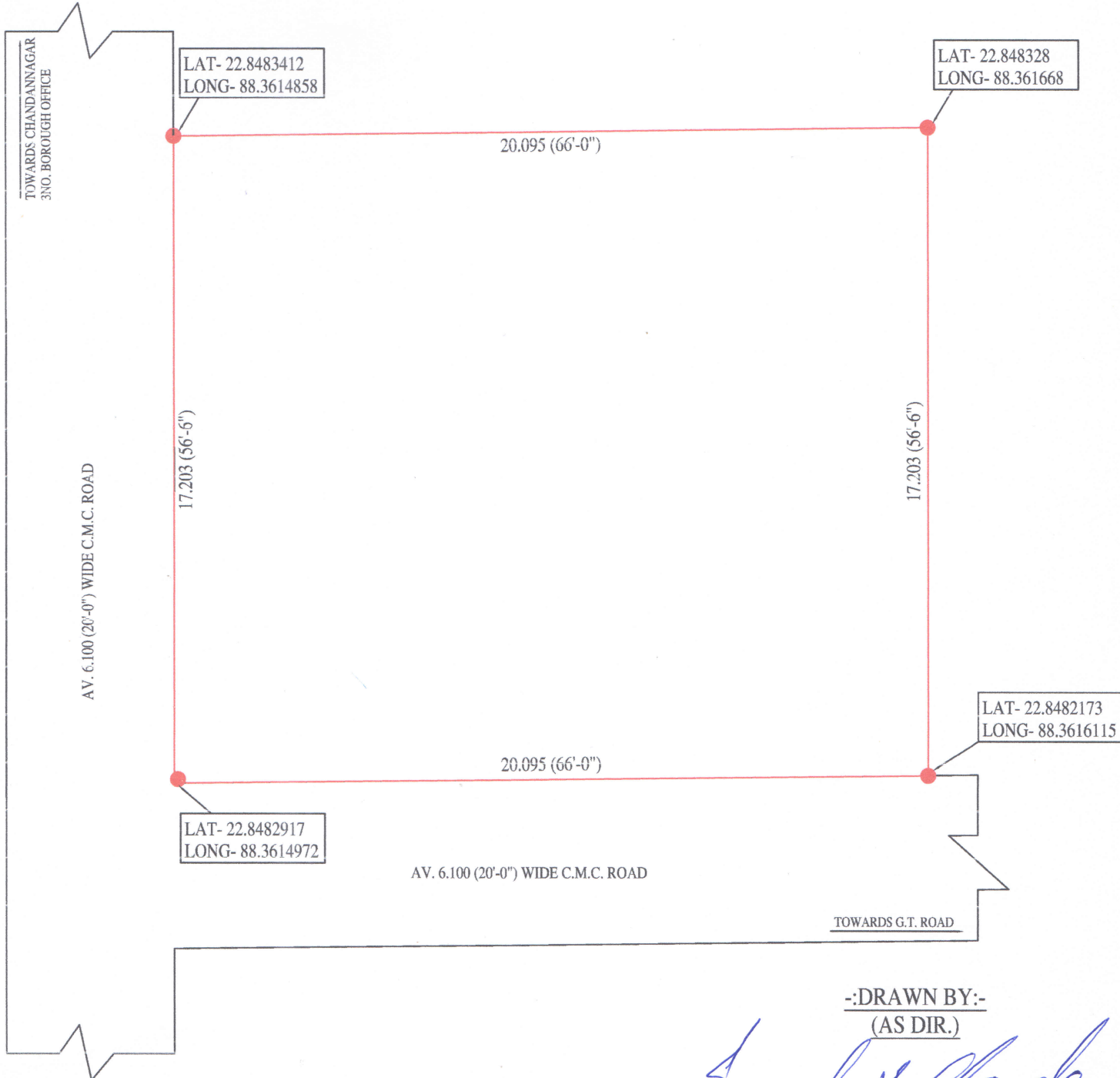

-:DRAWN BY:-
(AS DIR.)

Susendu Kumar Chanda

SUSENDU KUMAR CHANDA
Registered L. B. S.-1
Licence No.-13/490 (C.M.C.)